

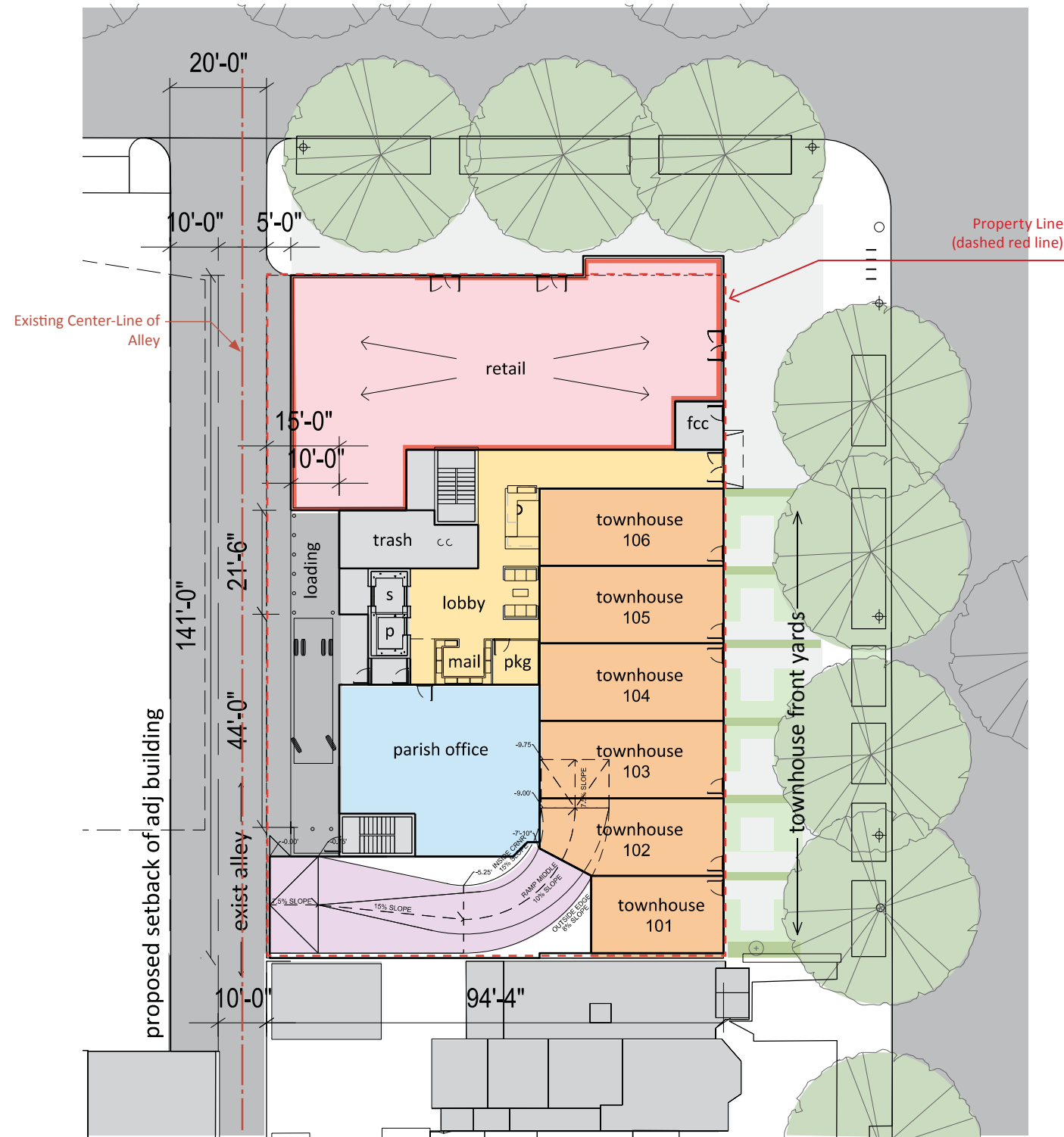

P1: Parking Level Demising Plan

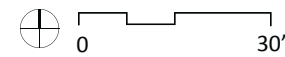

L1: Ground Level Demising Plan

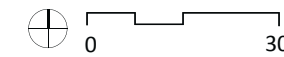

Property Line (dashed red line)

Existing Center-Line of Alley

proposed setback of adj building

townhouse front yards

Key

- Parking
- Service
- Lobby
- Lobby
- Parish Hall
- Retail
- Townhouse
- (A) 1 BR
- (A) 2 BR
- 1 BR
- 2 BR

- \*Notes\***
- 1 - (A) designates affordable unit
  - 2 - Refer to Pages 30 - 31 for Landscape Drawings
  - 3 - Unit demising may change as unit layouts are developed



**LEED v2009 for New Construction**  
 8th & O Street  
 February 22, 2017



**18 4 4 Sustainable Sites Possible Points: 26**

Y	M	N			
Y			Prereq 1	Construction Activity Pollution Prevention	
1			Credit 1	Site Selection	1
5			Credit 2	Development Density and Community Connectivity	5
		1	Credit 3	Brownfield Redevelopment	1
6			Credit 4.1	Alternative Transportation—Public Transportation Access	6
	1		Credit 4.2	Alternative Transportation—Bicycle Storage and Changing Rooms	1
3			Credit 4.3	Alternative Transportation—Low-Emitting and Fuel-Efficient Vehicles	3
	2		Credit 4.4	Alternative Transportation—Parking Capacity	2
	1		Credit 5.1	Site Development—Protect or Restore Habitat	1
1			Credit 5.2	Site Development—Maximize Open Space	1
1			Credit 6.1	Stormwater Design—Quantity Control	1
		1	Credit 6.2	Stormwater Design—Quality Control	1
1			Credit 7.1	Heat Island Effect—Non-roof	1
		1	Credit 7.2	Heat Island Effect—Roof	1
		1	Credit 8	Light Pollution Reduction	1

**6 0 4 Water Efficiency Possible Points: 10**

Y	M	N			
Y			Prereq 1	Water Use Reduction—20% Reduction	
2		2	Credit 1	Water Efficient Landscaping	2 to 4
		2	Credit 2	Innovative Wastewater Technologies	2
4			Credit 3	Water Use Reduction	2 to 4

**11 2 22 Energy and Atmosphere Possible Points: 35**

Y	M	N			
Y			Prereq 1	Fundamental Commissioning of Building Energy Systems	
Y			Prereq 2	Minimum Energy Performance	
Y			Prereq 3	Fundamental Refrigerant Management	
6		13	Credit 1	Optimize Energy Performance	1 to 19
		7	Credit 2	On-Site Renewable Energy	1 to 7
2			Credit 3	Enhanced Commissioning	2
2			Credit 4	Enhanced Refrigerant Management	2
1		2	Credit 5	Measurement and Verification	3
	2		Credit 6	Green Power	2

**5 1 8 Materials and Resources Possible Points: 14**

Y	M	N			
Y			Prereq 1	Storage and Collection of Recyclables	
		3	Credit 1.1	Building Reuse—Maintain Existing Walls, Floors, and Roof	1 to 3
		1	Credit 1.2	Building Reuse—Maintain 50% of Interior Non-Structural Elements	1
2			Credit 2	Construction Waste Management	1 to 2
		2	Credit 3	Materials Reuse	1 to 2
1	1		Credit 4	Recycled Content	1 to 2
2			Credit 5	Regional Materials	1 to 2
		1	Credit 6	Rapidly Renewable Material	1
		1	Credit 7	Certified Wood	1

**8 1 6 Indoor Environmental Quality Possible Points: 15**

Y	M	N			
Y			Prereq 1	Minimum Indoor Air Quality Performance	
Y			Prereq 2	Environmental Tobacco Smoke (ETS) Control	
		1	Credit 1	Outdoor Air Delivery Monitoring	1
		1	Credit 2	Increased Ventilation	1
1			Credit 3.1	Construction IAQ Management Plan—During Construction	1
		1	Credit 3.2	Construction IAQ Management Plan—Before Occupancy	1
1			Credit 4.1	Low-Emitting Materials—Adhesives and Sealants	1
1			Credit 4.2	Low-Emitting Materials—Paints and Coatings	1
1			Credit 4.3	Low-Emitting Materials—Flooring Systems	1
		1	Credit 4.4	Low-Emitting Materials—Composite Wood and Agrifiber Products	1
	1		Credit 5	Indoor Chemical and Pollutant Source Control	1
1			Credit 6.1	Controllability of Systems—Lighting Controls	1
1			Credit 6.2	Controllability of Systems—Thermal Comfort	1
1			Credit 7.1	Thermal Comfort—Design	1
		1	Credit 7.2	Thermal Comfort—Verification	1
		1	Credit 8.1	Daylight and Views—Daylight	1
1			Credit 8.2	Daylight and Views—Views	1

**6 0 0 Innovation and Design Process Possible Points: 6**

Y	M	N			
1			Credit 1.1	Innovation in Design: Exemplary Performance SS C7.1	1
1			Credit 1.2	Innovation in Design: Exemplary Performance SSC4.1	1
1			Credit 1.3	Innovation in Design: Green Housekeeping	1
1			Credit 1.4	Innovation in Design: Exemplary Performance Wec3	1
1			Credit 1.5	Innovation in Design: Integrated Pest Management	1
1			Credit 2	LEED Accredited Professional	1

**1 1 2 Regional Priority Credits (Zip Code 20002) Possible Points: 4**

Y	M	N			
		1	Credit 1.1	Regional Priority: EAc1 40% new/ 36% existing	1
1			Credit 1.2	Regional Priority: <b>SSc6.1</b>	1
	1		Credit 1.3	Regional Priority: <b>SSc5.1</b>	1
		1	Credit 1.4	Regional Priority: <b>EA Cr. 2 (1%), Wec2, or MRC1.1(75%)</b>	1

**55 9 46 Total Possible Points: 110**

